



SMOU LIFTS

FUJI HIGH-TECH ELEVATOR SUBMITTAL



SMOU

FUJI

MONA200

MONADRIVE®

永磁同步无齿轮曳引机

PERMANENT MAGNET SYNCHRONOUS GEARLESS TRACTION MACHINE

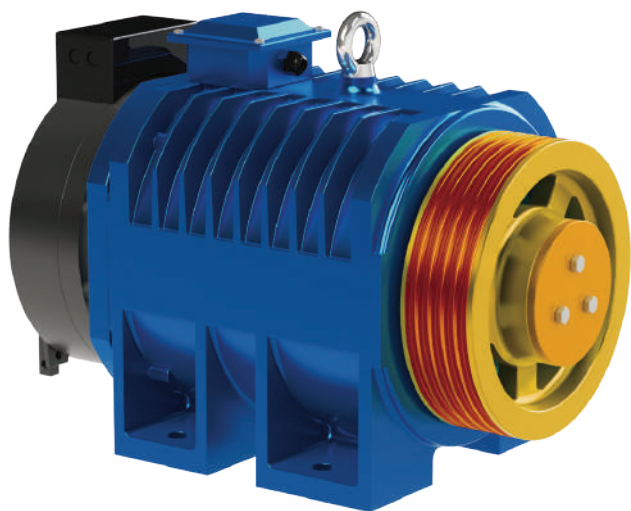

| | | |
|---------|----------------|---|
| ● 电源电压 | Voltage | 220V / 380V |
| ● 曳引比 | Roping | 1:1 / 2:1 |
| ● 额定载重 | Load | (320~630)kg |
| ● 额定梯速 | Elv. Speed | (0.4~1.75)m/s |
| ● 曳引轮节径 | Sheave Diam. | (Φ 200 / Φ 240 / Φ 320)mm |
| ● 防护等级 | IP Code | IP41 |
| ● 绝缘等级 | Ins. Class | F |
| ● 最大轴静载 | Max. Axle Load | 2500kg |
| ● 工作制 | Duty | S5-40% |
| ● 自重 | Weight | 200kg |

☉ 制动器型号 Brake Type **EMM600** 电压U / 电流I DC110V / 2.5A^{*3}

安装尺寸图 DIMENSIONS

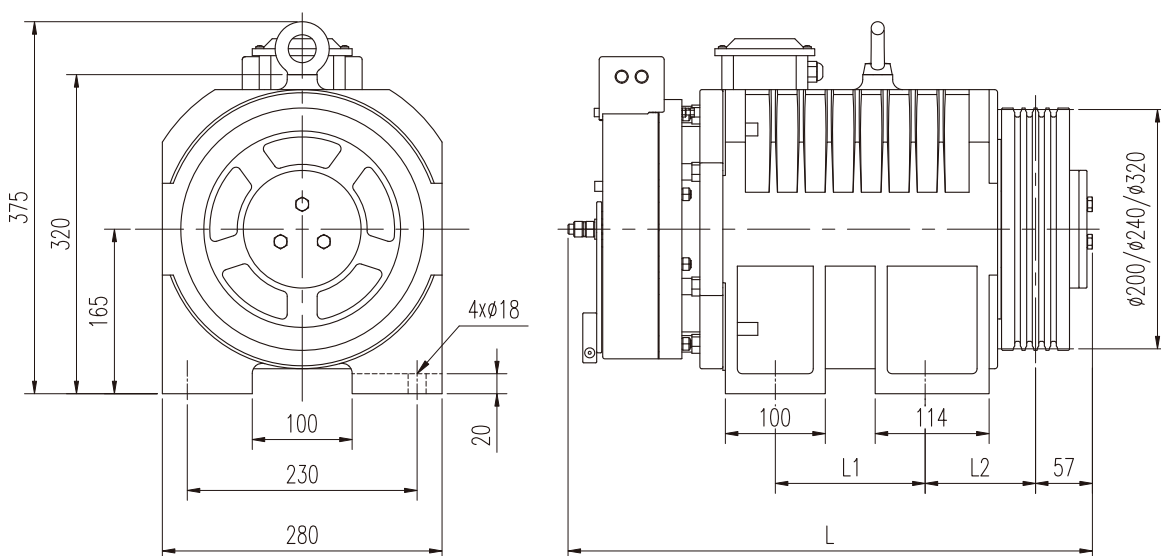

| 型号 | Type | MONA200 | | | | | | | | | | | | | |
|-----------------------|------|------------|--------------|---------------|-----------|---------|-------|-------|-------|--------|-----------|-----|-----|-------|------------------|
| 规格 | 额定载重 | 额定梯速 | 曳引轮直径 | 曳引轮绳槽 | 电源电压 | 额定电流 | 额定功率 | 额定转速 | 额定频率 | 额定转矩 | 极数 | L | L1 | L2 | 切口角 ⁴ |
| Spec. | Load | Elv. Speed | Sheave Diam. | Sheave Groove | Voltage | Current | Power | Speed | Freq. | Torque | Poles | mm | mm | mm | β Angle |
| | kg | m/s | mm | | V | A | kW | r/min | Hz | N·m | | | | | ° |
| Roping 曳引比 2:1 | | | | | | | | | | | | | | | |
| 320-0.4A | 320 | 0.4 | 200 | 3×Φ8×12 | 220 / 380 | 5 / 3 | 0.9 | 76 | 10.1 | 110 | 16 | 430 | 100 | 100.5 | 90 |
| 320-0.5A | 320 | 0.5 | | 3×Φ8×12 | 220 / 380 | 7 / 5 | 1.1 | 95 | 12.7 | 110 | 16 | | | | |
| 320-0.63A | 320 | 0.63 | | 3×Φ8×12 | 220 / 380 | 7 / 5 | 1.4 | 120 | 16.0 | 110 | 16 | | | | |
| 320-1.0A | 320 | 1.0 | | 3×Φ8×12 | 220 / 380 | 10 / 6 | 2.2 | 191 | 25.5 | 110 | 16 | | | | |
| 400-0.4A | 400 | 0.4 | 200 | 4×Φ8×12 | 220 / 380 | 6 / 4 | 1.1 | 76 | 10.1 | 140 | 16 | 430 | 100 | 100.5 | |
| 400-0.5A | 400 | 0.5 | | 4×Φ8×12 | 220 / 380 | 9 / 6 | 1.4 | 95 | 12.7 | 140 | 16 | | | | |
| 400-0.63A | 400 | 0.63 | | 4×Φ8×12 | 220 / 380 | 9 / 6 | 1.8 | 120 | 16.0 | 140 | 16 | | | | |
| 400-1.0A | 400 | 1.0 | | 4×Φ8×12 | 220 / 380 | 13 / 7 | 2.8 | 191 | 25.5 | 140 | 16 | | | | |
| 450-0.4A | 450 | 0.4 | 200 | 4×Φ8×12 | 220 / 380 | 7 / 5 | 1.2 | 76 | 10.1 | 150 | 16 | 430 | 100 | 100.5 | |
| 450-0.5A | 450 | 0.5 | | 4×Φ8×12 | 220 / 380 | 9 / 6 | 1.5 | 95 | 12.7 | 150 | 16 | | | | |
| 450-0.63A | 450 | 0.63 | | 4×Φ8×12 | 220 / 380 | 9 / 6 | 1.9 | 120 | 16.0 | 150 | 16 | | | | |
| 450-1.0A | 450 | 1.0 | | 4×Φ8×12 | 220 / 380 | 14 / 8 | 3.0 | 191 | 25.5 | 150 | 16 | | | | |
| 630-0.4A | 630 | 0.4 | 200 | 4×Φ8×12 | 220 / 380 | 8 / 6 | 1.7 | 76 | 10.1 | 210 | 16 | 520 | 150 | 110.5 | |
| 630-0.5A | 630 | 0.5 | | 4×Φ8×12 | 220 / 380 | 13 / 7 | 2.1 | 95 | 12.7 | 210 | 16 | | | | |
| 630-0.63A | 630 | 0.63 | | 4×Φ8×12 | 220 / 380 | 13 / 7 | 2.6 | 120 | 16.0 | 210 | 16 | | | | |
| 630-1.0A | 630 | 1.0 | | 4×Φ8×12 | 220 / 380 | 17 / 10 | 4.2 | 191 | 25.5 | 210 | 16 | | | | |
| 320-0.4B | 320 | 0.4 | 240 | 3×Φ8×12 | 220 / 380 | 6 / 4 | 0.9 | 64 | 8.5 | 130 | 16 | 430 | 100 | 100.5 | |
| 320-0.5B | 320 | 0.5 | | 3×Φ8×12 | 220 / 380 | 7 / 5 | 1.1 | 80 | 10.7 | 130 | 16 | | | | |
| 320-0.63B | 320 | 0.63 | | 3×Φ8×12 | 220 / 380 | 7 / 5 | 1.4 | 100 | 13.3 | 130 | 16 | | | | |
| 320-1.0B | 320 | 1.0 | | 3×Φ8×12 | 220 / 380 | 10 / 6 | 2.2 | 159 | 21.2 | 130 | 16 | | | | |
| 400-0.4B | 400 | 0.4 | 240 | 4×Φ8×12 | 220 / 380 | 7 / 5 | 1.1 | 64 | 8.5 | 160 | 16 | 430 | 100 | 100.5 | |
| 400-0.5B | 400 | 0.5 | | 4×Φ8×12 | 220 / 380 | 9 / 6 | 1.3 | 80 | 10.7 | 160 | 16 | | | | |
| 400-0.63B | 400 | 0.63 | | 4×Φ8×12 | 220 / 380 | 9 / 6 | 1.7 | 100 | 13.3 | 160 | 16 | | | | |
| 400-1.0B | 400 | 1.0 | | 4×Φ8×12 | 220 / 380 | 12 / 7 | 2.7 | 159 | 21.2 | 160 | 16 | | | | |
| 450-0.4B | 450 | 0.4 | 240 | 4×Φ8×12 | 220 / 380 | 8 / 5 | 1.2 | 64 | 8.5 | 180 | 16 | 520 | 150 | 110.5 | |
| 450-0.5B | 450 | 0.5 | | 4×Φ8×12 | 220 / 380 | 9 / 6 | 1.5 | 80 | 10.7 | 180 | 16 | | | | |
| 450-0.63B | 450 | 0.63 | | 4×Φ8×12 | 220 / 380 | 9 / 6 | 1.9 | 100 | 13.3 | 180 | 16 | | | | |
| 450-1.0B | 450 | 1.0 | | 4×Φ8×12 | 220 / 380 | 13 / 8 | 3.0 | 159 | 21.2 | 180 | 16 | | | | |
| 630-0.4B | 630 | 0.4 | 240 | 4×Φ8×12 | 220 / 380 | 10 / 8 | 1.7 | 64 | 8.5 | 260 | 16 | 520 | 150 | 110.5 | |
| 630-0.5B | 630 | 0.5 | | 4×Φ8×12 | 220 / 380 | 12 / 8 | 2.2 | 80 | 10.7 | 260 | 16 | | | | |
| 630-0.63B | 630 | 0.63 | | 4×Φ8×12 | 220 / 380 | 12 / 8 | 2.7 | 100 | 13.3 | 260 | 16 | | | | |
| 630-1.0B | 630 | 1.0 | | 4×Φ8×12 | 220 / 380 | 16 / 10 | 4.3 | 159 | 21.2 | 260 | 16 | | | | |
| 320-0.5C | 320 | 0.5 | 320 | 3×Φ8×12 | 220 / 380 | 6 / 5 | 1.1 | 60 | 8.0 | 170 | 16 | 430 | 100 | 100.5 | |
| 320-0.63C | 320 | 0.63 | | 3×Φ8×12 | 220 / 380 | 6 / 5 | 1.3 | 75 | 10.0 | 170 | 16 | | | | |
| 320-1.0C | 320 | 1.0 | | 3×Φ8×12 | 220 / 380 | 9 / 6 | 2.1 | 119 | 15.9 | 170 | 16 | | | | |
| 400-0.5C | 400 | 0.5 | 320 | 4×Φ8×12 | 220 / 380 | 8 / 5 | 1.4 | 60 | 12.0 | 220 | 24 | 520 | 150 | 110.5 | |
| 400-0.63C | 400 | 0.63 | | 4×Φ8×12 | 220 / 380 | 8 / 5 | 1.7 | 75 | 15.0 | 220 | 24 | | | | |
| 400-1.0C | 400 | 1.0 | | 4×Φ8×12 | 220 / 380 | 10 / 8 | 2.7 | 119 | 23.8 | 220 | 24 | | | | |
| 400-1.5C | 400 | 1.5 | | 4×Φ8×12 | 220 / 380 | 18 / 10 | 4.1 | 179 | 35.8 | 220 | 24 | | | | |
| 400-1.6C | 400 | 1.6 | | 4×Φ8×12 | 220 / 380 | 18 / 10 | 4.4 | 191 | 38.2 | 220 | 24 | | | | |
| 400-1.75C | 400 | 1.75 | | 4×Φ8×12 | 220 / 380 | 18 / 10 | 4.8 | 209 | 41.8 | 220 | 24 | | | | |
| 450-0.5C | 450 | 0.5 | 320 | 4×Φ8×12 | 220 / 380 | 8 / 5 | 1.5 | 60 | 12.0 | 240 | 24 | 520 | 150 | 110.5 | |
| 450-0.63C | 450 | 0.63 | | 4×Φ8×12 | 220 / 380 | 8 / 5 | 1.9 | 75 | 15.0 | 240 | 24 | | | | |
| 450-1.0C | 450 | 1.0 | | 4×Φ8×12 | 220 / 380 | 11 / 9 | 3.0 | 119 | 23.8 | 240 | 24 | | | | |
| 450-1.5C | 450 | 1.5 | | 4×Φ8×12 | 220 / 380 | 19 / 11 | 4.5 | 179 | 35.8 | 240 | 24 | | | | |
| 450-1.6C | 450 | 1.6 | | 4×Φ8×12 | 220 / 380 | 19 / 11 | 4.8 | 191 | 38.2 | 240 | 24 | | | | |
| 450-1.75C | 450 | 1.75 | | 4×Φ8×12 | 220 / 380 | 19 / 11 | 5.3 | 209 | 41.8 | 240 | 24 | | | | |
| 630-0.5C | 630 | 0.5 | 320 | 5×Φ8×12 | 220 / 380 | 13 / 8 | 2.1 | 60 | 12.0 | 340 | 24 | 570 | 200 | 110.5 | |
| 630-0.63C | 630 | 0.63 | | 5×Φ8×12 | 220 / 380 | 13 / 8 | 2.7 | 75 | 15.0 | 340 | 24 | | | | |
| 630-1.0C | 630 | 1.0 | | 5×Φ8×12 | 220 / 380 | 16 / 11 | 4.2 | 119 | 23.8 | 340 | 24 | | | | |
| 630-1.5C | 630 | 1.5 | | 5×Φ8×12 | 220 / 380 | 27 / 16 | 6.4 | 179 | 35.8 | 340 | 24 | | | | |
| 630-1.6C | 630 | 1.6 | | 5×Φ8×12 | 220 / 380 | 27 / 16 | 6.8 | 191 | 38.2 | 340 | 24 | | | | |
| 630-1.75C | 630 | 1.75 | | 5×Φ8×12 | 220 / 380 | 27 / 16 | 7.4 | 209 | 41.8 | 340 | 24 | | | | |
| Roping 曳引比 1:1 | | | | | | | | | | | | | | | |
| 320-0.4D | 320 | 0.4 | 200 | 4×Φ8×12 | 220 / 380 | 5 / 3 | 0.9 | 38 | 5.1 | 220 | 16 | 570 | 200 | 110.5 | 90 |
| 400-0.4D | 400 | 0.4 | 200 | 5×Φ8×12 | 220 / 380 | 6 / 4 | 1.1 | 38 | 5.1 | 270 | 16 | 570 | 200 | 110.5 | |

● 注 Notes:

- *1、本机型只用于无机房。The machine is only used for machine roomless.
- *2、本机型接线盒可选配于左置或者右置。(面对制动器) Facing the brake, junction box can be located on the left, right optionally.
- *3、制动器电压值表示启动/维持电压。Brake voltage corresponds to its starting and sustaining voltage.
- *4、此切口角为推荐值, 可根据客户需求非标切口角度。The undercut angle is recommended value, and it's optional according to p

Figure 2-5 System components of the NICE3000^{new}

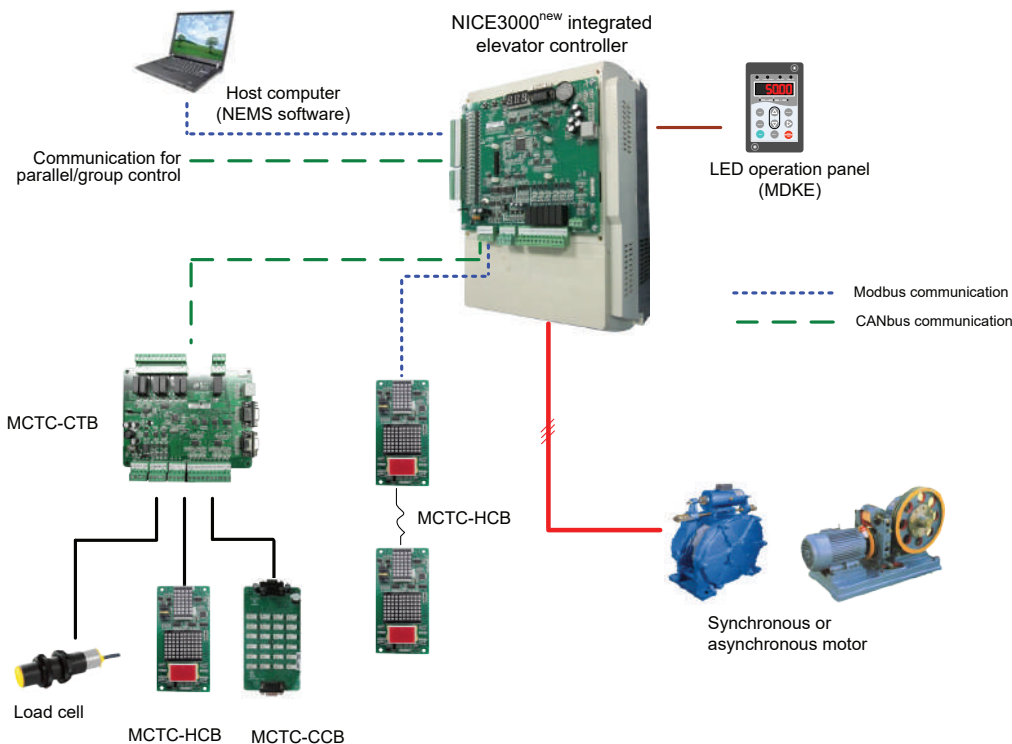

2

The NICE3000^{new} has the following functions in the system:

- It controls the motor based on feedback signals from the encoder, and records information of all position switches in the shaft by pulse, implementing accurate leveling and direct travel ride and guaranteeing running safety.
- It implements information collection and control of car-related components by means of CANbus communication with the MCTC-CTB.
- It registers and displays hall calls of all floors with easy address setting by means of Modbus communication with the MCTC-HCB.

The following figure shows the system structure of the NICE3000^{new}.

Figure 2-6 System structure of the NICE3000^{new}

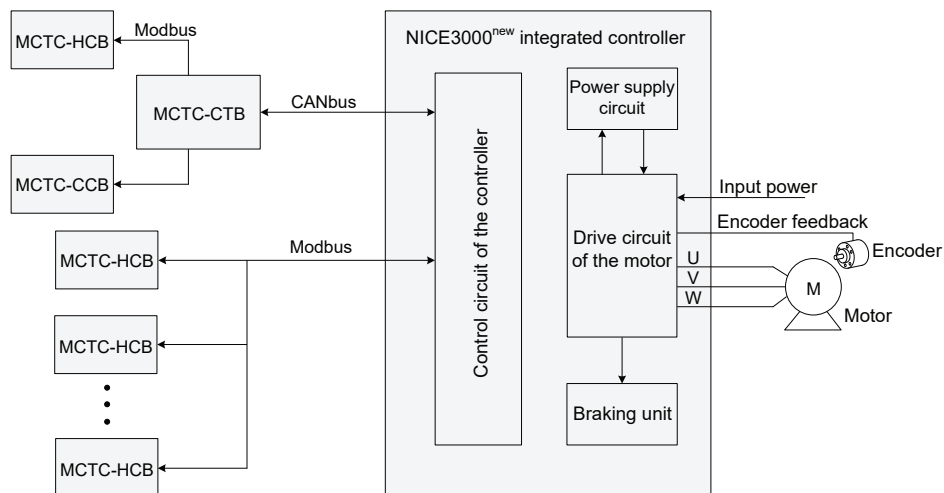

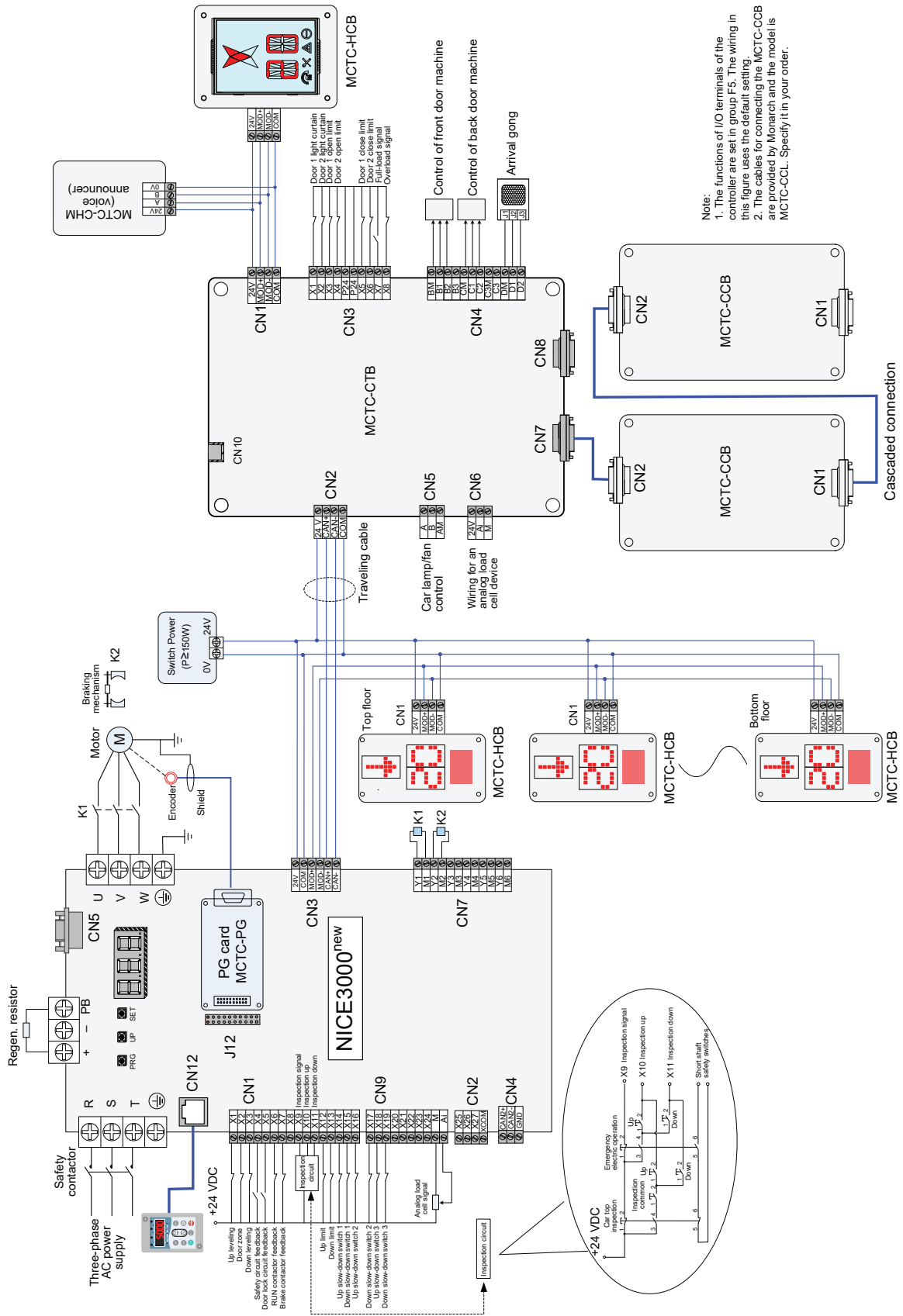

Note:
 1. The functions of I/O terminals of the controller are set in group P5. The wiring in this figure uses the default setting.
 2. The cables for connecting the MCTC-CBB are provided by Monarch and the model is MCTC-CCL. Specify it in your order.

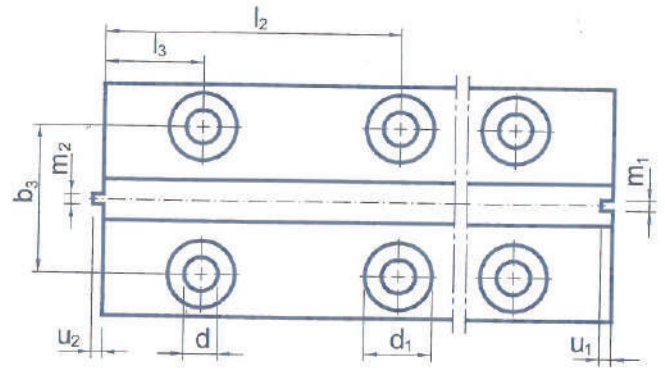
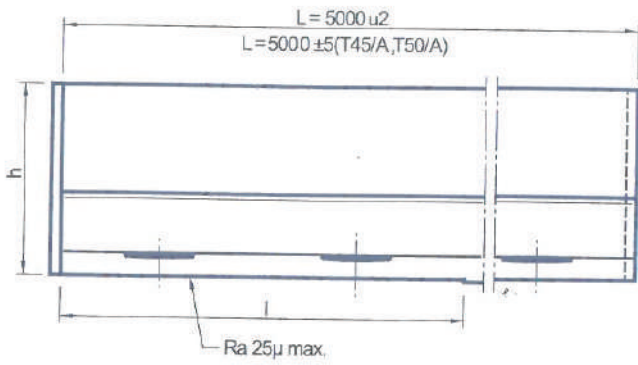

ISO 7465:2007

尺寸 (mm)
Dimensions (mm)

| | $b_1 \pm 1$ | $h_1 \pm 0,20$ | | | | | | | $k_2 \pm 0,15$ | | | | | | | $p \pm 0,50$ | r_s | $m_1^{+0,06}_{-0}$ | $m_2^{+0}_{-0,06}$ | $u_1 \pm 0,10$ | $u_2 \pm 0,10$ | 高线性度 / Straightness | | |
|-----------------|-------------|----------------|---------------------------------------|--------------|---------------|--------------------|--------------------|---------------|----------------|--------------|--------------|--------------|-------|--------------------|--------------------|----------------|----------------|--------------------|--------------------|----------------|----------------|---------------------|--------------|-------------|
| | | | | | | | | | | | | | | | | | | | | | | | f/5m max. mm | f/m max. mm |
| 冷拔 / Cold drawn | T45/A | 45 | 45 | | | | | | | 5 | | | | | | | 5 | 1 | 2 | 1,97 | 2,5 | 2 | 3,5 | 0,7 |
| | T50/A | 50 | 50 | | | | | | | 5 | | | | | | | 5 | 1 | 2 | 1,97 | 2,5 | 2 | 3,5 | 0,7 |
| | | $b_1 \pm 1,50$ | $A \pm 0,10$ $B \pm 0,75$ h_1 | $h \pm 0,08$ | l^{+3}_{-0} | $k_1^{+0,10}_{-0}$ | $k_2^{+0,10}_{-0}$ | n^{+3}_{-0} | c | $g \pm 0,75$ | $f \pm 0,75$ | $p \pm 0,75$ | r_s | $m_1^{+0,06}_{-0}$ | $m_2^{+0}_{-0,06}$ | $u_1 \pm 0,10$ | $u_2 \pm 0,10$ | | | | | | | |
| | T65/A | 65 | 54 | . | . | 7,9 | . | 20 | 5 | 4 | 5,8 | . | 3 | 2 | 1,97 | 2,5 | 2 | 3,5 | 0,7 | | | | | |
| | T70/A | 70 | 65 | . | . | 9 | . | 34 | 6 | 6 | 8 | . | 1,5 | 3 | 2,97 | 3,5 | 3 | 2,5 | 0,5 | | | | | |
| | T70-70-9/A | 70 | 70 | . | . | 9 | . | 35 | 7,9 | 8,5 | 8,5 | . | 3 | 3 | 2,97 | 3,5 | 3 | 2,5 | 0,5 | | | | | |
| | T75/A | 75 | 62 | . | . | 10 | . | 30 | 8 | 7 | 9 | . | 1,5 | 3 | 2,97 | 3,5 | 3 | 2,5 | 0,5 | | | | | |
| | T80-80-9/A | 80 | 80 | . | . | . | 9 | . | . | . | . | 9 | 3 | 3 | 2,97 | 3,5 | 3 | 2,5 | 0,5 | | | | | |
| | T82/A | 82 | 68 | . | . | 9 | . | 34 | 7,5 | 6 | 8,25 | . | 3 | 3 | 2,97 | 3,5 | 3 | 2,5 | 0,5 | | | | | |
| | T89/A | 89 | 62 | . | . | 16 | . | 34 | 10 | 8 | 11 | . | 3 | 6,4 | 6,37 | 7,14 | 6,35 | 2,5 | 0,5 | | | | | |
| | T90/A | 90 | 75 | . | . | 16 | . | 42 | 10 | 8 | 10 | . | 4 | 6,4 | 6,37 | 7,14 | 6,35 | 2,5 | 0,5 | | | | | |
| | T125-L1/A | 125 | 68 | . | . | . | 9 | . | . | 6 | 8,25 | . | 3 | 3 | 2,97 | 3,5 | 3 | 2,5 | 0,5 | | | | | |
| 机加工 / Machined | T75/B | 75 | 62 | 61 | 138 | 10 | . | 30 | 8 | 7 | 9 | . | 3 | 3 | 2,97 | 3,5 | 3 | 2 | 0,4 | | | | | |
| | T78/B | 78 | 56 | 55 | 138 | 10 | . | 26 | 7 | 6 | 8,5 | . | 2,5 | 3 | 2,97 | 3,5 | 3 | 2 | 0,4 | | | | | |
| | T82/B | 82 | 68 | 66,6 | 111 | 9 | . | 34 | 7,5 | 6 | 8,25 | . | 3 | 3 | 2,97 | 3,5 | 3 | 2 | 0,4 | | | | | |
| | T89/B | 89 | 62 | 61 | 156 | 16 | . | 34 | 10 | 8 | 11 | . | 3 | 6,4 | 6,37 | 7,14 | 6,35 | 1,75 | 0,35 | | | | | |
| | T90/B | 90 | 75 | 74 | 156 | 16 | . | 42 | 10 | 8 | 10 | . | 4 | 6,4 | 6,37 | 7,14 | 6,35 | 1,75 | 0,35 | | | | | |
| | T114/B | 114 | 89 | 88 | 156 | 16 | . | 38 | 9,5 | 8 | 11 | . | 4 | 6,4 | 6,37 | 7,14 | 6,35 | 1,5 | 0,3 | | | | | |
| | T125/B | 125 | 82 | 81 | 156 | 16 | . | 42 | 10 | 8 | 12 | . | 4 | 6,4 | 6,37 | 7,14 | 6,35 | 1,5 | 0,3 | | | | | |
| | T127-1/B | 127 | 89 | 88 | 156 | 16 | . | 45 | 10 | 8 | 11 | . | 4 | 6,4 | 6,37 | 7,14 | 6,35 | 1,5 | 0,3 | | | | | |
| | T127-2/B | 127 | 89 | 88 | 156 | 16 | . | 51 | 10 | 12,7 | 15,9 | . | 5 | 6,4 | 6,37 | 7,14 | 6,35 | 1,5 | 0,3 | | | | | |
| | T140-1/B | 140 | 108 | 107 | 193 | 19 | . | 51 | 12,7 | 12,7 | 15,9 | . | 5 | 6,4 | 6,37 | 7,14 | 6,35 | 1,5 | 0,3 | | | | | |
| | T140-2/B | 140 | 102 | 101 | 193 | 28,6 | . | 51 | 17,5 | 14,5 | 17,5 | . | 5 | 6,4 | 6,37 | 7,14 | 6,35 | 1,5 | 0,3 | | | | | |
| | T140-3/B | 140 | 127 | 126 | 193 | 31,75 | . | 57 | 19 | 17,5 | 25,4 | . | 5 | 6,4 | 6,37 | 7,14 | 6,35 | 1,5 | 0,3 | | | | | |



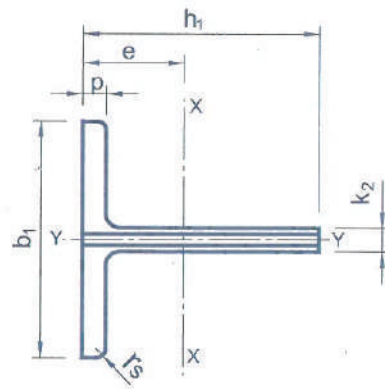
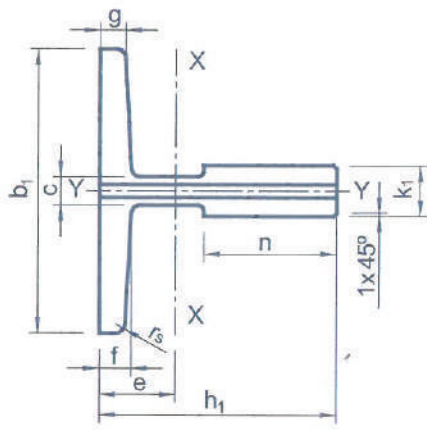

导轨、连接板和螺栓的尺寸和导轨、连接板的孔距 / Dimensions and distance between holes, fishplates and bolts

连接板及螺栓的孔距(mm.)
Distance between holes, fishplates and bolts(mm.)

| | 型号 | d | | b ₂ | b ₃ ± 0,20 | l ₁ ⁺³ ₋₀ | l ₂ ± 0,20 | l ₃ ± 0,20 | V ⁺³ ₋₀ | 螺栓 | 垫圈 |
|-----------------|------------|------|----------------|----------------|-----------------------|--|-----------------------|-----------------------|-------------------------------|--------|--------|
| | Type | | | | | | | | | Bolt | Washer |
| 冷拔 / Cold drawn | T45/A | 9 | | 50 | 25 | 160 | 65 | 15 | 8 | M8X25 | A-8 |
| | T50A | 9 | | 50 | 30 | 200 | 75 | 25 | 8 | M8X25 | A-8 |
| | | d | d ₁ | b ₂ | b ₃ ± 0,20 | l ₁ ⁺³ ₋₀ | l ₂ ± 0,20 | l ₃ ± 0,20 | V ⁺³ ₋₀ | 螺栓 | 垫圈 |
| | T65/A | 10,5 | • | 65 | 40 | 160 | 65 | 15 | 8 | M10X25 | A-10 |
| | T70/A | 13 | 26 | 70 | 42 | 250 | 105 | 25 | 10 | M12x35 | A-12 |
| | T70-70-9/A | 13 | • | 70 | 42 | 250 | 105 | 25 | 10 | M12x35 | A-12 |
| | T75/A | 13 | 26 | 70 | 42 | 250 | 105 | 25 | 10 | M12x35 | A-12 |
| | T80-80-9/A | 13 | • | 80 | 42 | 250 | 105 | 25 | 10 | M12x35 | A-12 |
| | T82/A | 13 | 26 | 80 | 50,8 | 216 | 81 | 27 | 10 | M12x35 | A-12 |
| | T89/A | 13 | 26 | 90 | 57,2 | 305 | 114,3 | 38,1 | 13 | M12x35 | A-12 |
| | T90/A | 13 | 26 | 90 | 57,2 | 305 | 114,3 | 38,1 | 13 | M12x35 | A-12 |
| T125-L1/A | 17 | 33 | 130 | 79,4 | 305 | 114,3 | 38,1 | 18 | M16x50 | A-16 | |
| 机加工 / Machined | T75/B | 13 | 26 | 70 | 42 | 250 | 105 | 25 | 10 | M12x35 | A-12 |
| | T78/B | 13 | 26 | 70 | 42 | 250 | 105 | 25 | 10 | M12x35 | A-12 |
| | T82/B | 13 | 26 | 80 | 50,8 | 216 | 81 | 27 | 10 | M12x35 | A-12 |
| | T89/B | 13 | 26 | 90 | 57,2 | 305 | 114,3 | 38,1 | 13 | M12x35 | A-12 |
| | T90/B | 13 | 26 | 90 | 57,2 | 305 | 114,3 | 38,1 | 13 | M12x35 | A-12 |
| | T114/B | 17 | 33 | 120 | 70 | 305 | 114,3 | 38,1 | 18 | M16x50 | A-16 |
| | T125/B | 17 | 33 | 130 | 79,4 | 305 | 114,3 | 38,1 | 18 | M16x50 | A-16 |
| | T127-1/B | 17 | 33 | 130 | 79,4 | 305 | 114,3 | 38,1 | 18 | M16x50 | A-16 |
| | T127-2/B | 17 | 33 | 130 | 79,4 | 305 | 114,3 | 38,1 | 18 | M16x50 | A-16 |
| | T140-1/B | 21 | 40 | 140 | 92,1 | 380 | 152,4 | 31,8 | 28 | M20x65 | A-20 |
| | T140-2/B | 21 | 40 | 140 | 92,1 | 380 | 152,4 | 31,8 | 28 | M20x65 | A-20 |
| T140-3/B | 21 | 40 | 140 | 92,1 | 380 | 152,4 | 31,8 | 38 | M20x80 | A-20 | |

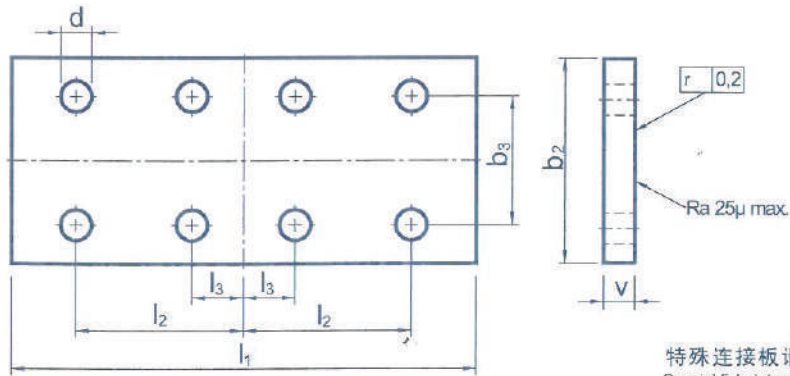

标准连接板
Standard fishplate.

特殊连接板请见目录
Special fishplates in Fishplates catalogue.

ISO 7465:2007

导轨主要参数

General Characteristics of
the Guides

| 标准 Standards | 机械性能 / Mechanical Characteristics | | | |
|-------------------|---|---|--|-----------------------------|
| | | 抗拉强度 Breaking point N/mm ² | 屈服点 Yield point N/mm ² min. | 伸长率 Elongation % min. |
| ISO 7465 | | | | |
| UNI 7465 | 冷拔导向面>5mm≤8mm Cold drawn blade>5mm≤8mm (EN 10277-2) | 470 - 840 | 355 | 8 |
| ANSI A 17-1 | | | | |
| BS 5655 | 冷拔导向面>8mm≤10mm Cold drawn blade>8mm≤10mm (EN 10277-2) | 470 - 840 | 355 | 12 |
| DIN 15311 | | | | |
| JIS | 冷拔导向面>10mm≤16mm Cold drawn blade>10mm≤16mm (EN 10277-2) | 420 - 710 | 300 | 12 |
| AFNOR NF P 92/251 | | | | |
| GB/T22562 - 2008 | 导向面≤16mm Blade ≤16mm | 410 - 520 | 275 | 22 |
| | 导向面>16mm Blade>16mm | 410 - 520 | 265 | 22 |

化学成分 Chemical Composition

| | C% | Mn% | P% | S% | Si% |
|------------------|------|------|-------|-------|------|
| | Max. | Max. | Max. | Max. | Max. |
| 冷拔 Cold drawn | 0,17 | 1,4 | 0,045 | 0,045 | 0,4 |
| 机加工 Machined | 0,21 | 1,5 | 0,045 | 0,045 | 0,4 |

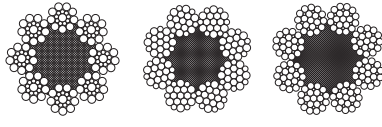

8 × 19S+FC

8 × 19W+FC

8 × 25Fi+FC

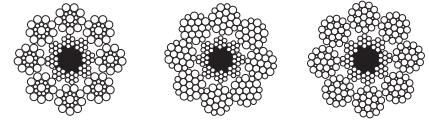

8 × 19S+CSC

8 × 19W+CSC

8 × 25Fi+CSC

| 公称直径 Nominal Diameter(mm) | 参考重量 Approximate Weight kg/100m | 钢丝绳最小破断拉力 (kN) (Min B/L) | | | | |
|---------------------------------|---------------------------------------|--|--|---|---|---|
| | | 双强度: 1370/1770N/mm ² (Double T/S) | 双强度: 1570/1770N/mm ² 1620/1770N/mm ² (Double T/S) | 单强度: 1570N/mm ² (Single T/S) | 单强度: 1620N/mm ² (Single T/S) | 单强度: 1770N/mm ² (Single T/S) |
| 8 | 22,2 | 28,1 | 30,8 | 29,4 | 30,4 | 33,2 |
| 9 | 28,1 | 35,6 | 38,9 | 37,3 | 38,4 | 42,0 |
| 9,5 | 31,3 | 39,7 | 43,6 | 41,5 | 42,8 | 46,8 |
| 10 | 34,7 | 44,0 | 48,1 | 46,0 | 47,5 | 51,9 |
| 11 | 42,0 | 53,2 | 58,1 | 55,6 | 57,4 | 62,8 |
| 12 | 50,0 | 63,3 | 69,2 | 66,2 | 68,4 | 74,7 |
| 12,7 | 56,0 | 70,9 | 77,5 | 74,2 | 76,6 | 83,6 |
| 13 | 58,6 | 74,3 | 81,2 | 77,7 | 80,2 | 87,6 |
| 14 | 67,9 | 86,1 | 94,2 | 90,2 | 93,0 | 102,0 |
| 16 | 88,8 | 113,0 | 123 | 118,0 | 122 | 133,0 |
| 19 | 125,0 | 159,0 | 173 | 166,0 | 171 | 187,0 |

注: 也可提供其他强度级别的钢丝绳

Note: other strength grade wire rope can also be provided.

| 公称直径 Nominal Diameter(mm) | 参考重量 Approximate Weight kg/100m | 钢丝绳最小破断拉力 (kN) (Min B/L) | | | | |
|---------------------------------|---------------------------------------|--|--|---|---|---|
| | | 双强度: 1370/1770N/mm ² (Double T/S) | 双强度: 1570/1770N/mm ² (Double T/S) | 单强度: 1570N/mm ² (Single T/S) | 单强度: 1770N/mm ² (Single T/S) | 单强度: 1960N/mm ² (Single T/S) |
| 6 | 14,2 | 20,1 | 21,4 | 20,1 | 22,7 | 25,1 |
| 6,5 | 16,7 | 23,6 | 25,6 | 23,6 | 26,6 | 29,5 |
| 8 | 25,5 | 35,8 | 38,0 | 35,8 | 40,3 | / |
| 9 | 32,5 | 45,3 | 48,2 | 45,3 | 51,0 | / |
| 9,5 | 36,0 | 50,4 | 53,7 | 50,4 | 56,9 | / |
| 10 | 39,7 | 55,9 | 59,5 | 55,9 | 63,0 | / |
| 11 | 48,5 | 67,6 | 79,1 | 67,6 | 76,2 | / |
| 12 | 57,5 | 80,6 | 85,6 | 80,6 | 90,7 | / |
| 12,7 | 64,0 | 90,1 | 95,9 | 90,1 | 102,0 | / |
| 13 | 68,0 | 94,5 | 100 | 94,5 | 106,0 | / |
| 14 | 78,5 | 110,0 | 117 | 110,0 | 124,0 | / |
| 16 | 102 | 143,0 | 152 | 143,0 | 161,0 | / |
| 19 | 144 | 202,0 | 215 | 202,0 | 227,0 | / |

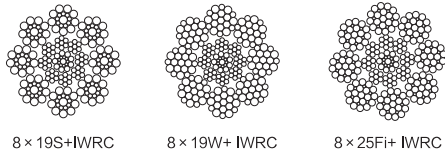

8 × 19S+IWRC

8 × 19W+ IWRC

8 × 25Fi+ IWRC

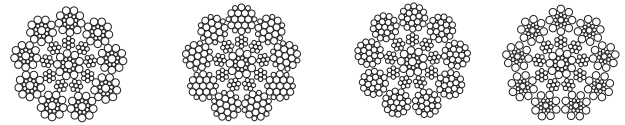

9 × 19S+IWRC

9 × 19W+IWRC

9 × 25Fi+IWRC

9 × 17S+IWRC

| 公称直径 Nominal Diameter(mm) | 参考重量 Approximate Weight kg/100m | 钢丝绳最小破断拉力 (kN) (Min B/L) | | | | |
|---------------------------------|---------------------------------------|--|--|---|---|---|
| | | 双强度: 1370/1770N/mm ² (Double T/S) | 双强度: 1570/1770N/mm ² (Double T/S) | 单强度: 1570N/mm ² (Single T/S) | 单强度: 1770N/mm ² (Single T/S) | 单强度: 1960N/mm ² (Single T/S) |
| 6 | 15,2 | 21,2 | 22,6 | 21,2 | 23,9 | 26,5 |
| 6,5 | 17,8 | 24,9 | 26,5 | 24,9 | 28 | 31 |
| 8 | 26,5 | 37,7 | 40,1 | 37,7 | 42,5 | 47,1 |
| 10 | 42,0 | 58,9 | 62,6 | 58,9 | 66,3 | 73,4 |
| 11 | 51,1 | 71,2 | 75,3 | 71,2 | 80,3 | 88,9 |
| 12 | 62,0 | 84,8 | 90,2 | 84,8 | 95,6 | 106 |
| 12,7 | 68,1 | 95 | 101 | 95 | 107 | 119 |
| 13 | 69,8 | 98,8 | 105 | 98,8 | 111 | 123 |
| 16 | 107 | 150 | 160 | 150 | 169 | 187 |

| 公称直径 Nominal Diameter(mm) | 参考重量 Approximate Weight kg/100m | 钢丝绳最小破断拉力 (kN) (Min B/L) | | | | |
|---------------------------------|---------------------------------------|--|--|---|---|---|
| | | 双强度: 1370/1770N/mm ² (Double T/S) | 双强度: 1570/1770N/mm ² (Double T/S) | 单强度: 1570N/mm ² (Single T/S) | 单强度: 1770N/mm ² (Single T/S) | 单强度: 1960N/mm ² (Single T/S) |
| 8 | 27,5 | 39,4 | 41,9 | 39,4 | 44,4 | 49,2 |
| 9 | 34,8 | 49,9 | 53 | 49,9 | 56,2 | 62,3 |
| 10 | 43,0 | 61,5 | 65,5 | 61,5 | 69,4 | 76,8 |
| 11 | 52,0 | 74,5 | 79,2 | 74,5 | 84,0 | 93,0 |
| 12 | 61,9 | 88,6 | 94,3 | 88,6 | 99,9 | 110,6 |
| 13 | 72,7 | 104 | 111 | 104 | 117 | 129,8 |
| 14 | 84,3 | 121 | 128 | 121 | 136 | 151,0 |
| 16 | 110 | 158 | 168 | 158 | 178 | 197,0 |
| 19 | 155 | 222 | 236 | 222 | 250 | 277 |

6 × 19S+SFC(PP)

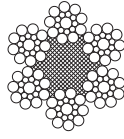

| 公称直径 Nominal Diameter(mm) | 参考重量 Approximate Weight kg/100m | 钢丝绳最小破断拉力 (kN) (Min B/L) | | | | |
|------------------------------|------------------------------------|--|--|---|---|---|
| | | 双强度: 1320/1770N/mm ² (Double T/S) | 双强度: 1370/1770N/mm ² (Double T/S) | 单强度: 1570N/mm ² (Single T/S) | 单强度: 1770N/mm ² (Single T/S) | 单强度: 1960N/mm ² (Single T/S) |
| 6.0 | 12.9 | 16.8 | 17.8 | 18.7 | 21.0 | 23.3 |
| 6.3 | 14.2 | 18.5 | 19.6 | 20.6 | 23.2 | 25.7 |
| 6.5 | 15.2 | 19.7 | 20.9 | 21.9 | 24.7 | 27.3 |
| 8.0 | 23.0 | 29.8 | 31.7 | 33.2 | 37.4 | 41.4 |
| 9.5 | 32.4 | 42 | 44.7 | 46.8 | 52.7 | 58.4 |

8 × 19S+SFC(PP)

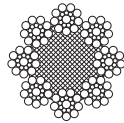

| 公称直径 Nominal Diameter(mm) | 参考重量 Approximate Weight kg/100m | 钢丝绳最小破断拉力 (kN) (Min B/L) | |
|------------------------------|------------------------------------|--|---|
| | | 双强度: 1370/1770 N/mm ² (Double T/S) | 单强度: 1570N/mm ² (Single T/S) |
| 8.0 | 21.8 | 28.1 | 29.4 |
| 9.5 | 30.7 | 39.7 | 41.5 |
| 10.0 | 34.0 | 44.0 | 46.0 |
| 12.7 | 54.8 | 70.9 | 74.2 |

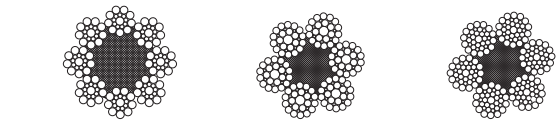

| 截面结构实例 Example of Seeliant Construction | | 钢丝绳结构 Steel Rope Construction | | 股结构 Strand Construction | |
|---|------------------------------|--|-----------------------|-------------------------------|-----------------------|
| 6 × 29FI+FC | 项目 Item | 数量 Number | 项目 Item | 数量 Number | |
| | 股数 Outer Strand | 6 | 钢丝 Wire | 25-41 | |
| | 股数 Outer Strand | 6 | 多层钢丝 Outer Wire | 12-16 | |
| | 股的层数 Layer of Strand | 1 | 层的层数 Layer of Wire | 2-3 | |
| | 钢丝绳股数 Wire Number of Rope | 150-246 | | | |
| | 典型例子 Typical | 外层钢丝的数量 Number of Outer Wire | | 外层钢丝系数 Ratio of Outer Wire | |
| 6 × 29FI 6 × 36WS | 1+7+7+14 1+7+7+14 | 84 | 每股 Per Strand | 14 | 0.056 |
| | | 钢丝绳类别 Steel Rope Type: 6 × 36 | | | |
| | | 最小破断力系数 Ratio of MBL | K1=0.330 | | |
| | | 单位重量系数 Ratio of Unit Weight | W1=0.367 | | |
| | | 金属断面系数 Ratio of Section | C1=0.393 | | |
| 钢丝绳公称直径 Nominal Diameter | 近似重量 Approximate Weight | 钢丝绳类别 Steel Rope Grade | | 最小破断力 (kN) | |
| mm | kg/100m | 6 × 36 类别 (包括 6 × 36WS 和 6 × 29FI) 6 × 36 Grade (Including 6 × 36WS and 6 × 29FI) | | 1570 等级 1570 Grade | 1770 等级 1770 Grade |
| 24 / 25 | 219 / 238 | | | 1960 等级 1960 Grade | 1960 等级 1960 Grade |
| 26 / 27 | 257 / 277 | | | 298 / 324 | 336 / 365 |
| 28 / 29 | 298 / 320 | | | 350 / 378 | 395 / 426 |
| 30 / 31 | 342 / 365 | | | 406 / 436 | 458 / 491 |
| 32 / 33 | 389 / 414 | | | 466 / 498 | 526 / 561 |
| 34 / 35 | 439 / 466 | | | 531 / 564 | 598 / 636 |
| 36 / 37 | 492 / 520 | | | 599 / 635 | 675 / 716 |
| 38 | 549 | | | 671 / 709 | 757 / 800 |
| | | | | 748 | 843 |

同时提供 8 股天然纤维芯、合成纤维芯、混合钢芯结构的补偿钢丝绳
Also provide 8 strands compensating ropes with natural core, PP core or semi-steel core.

Zn6 × 19+IWS

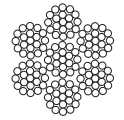

| 公称直径 Nominal Diameter(mm) | 参考重量 Approximate Weight kg/100m | 钢丝绳最小破断拉力 (kN) (Min B/L) |
|------------------------------|------------------------------------|--------------------------|
| 3.0 | 4.20 | 7.6 |
| 3.18(3.2) | 4.30 | 8.9 |
| 3.6 | 6.00 | 10.4 |

钢丝绳的捻法及捻向

所谓捻法是指股在绳中或丝在股中绕制时螺旋线的走向。钢丝绳的捻法有两种，即交互捻钢丝绳和同向捻钢丝绳。钢丝绳的捻向通常分为右交互捻、左交互捻、右同向捻、左同向捻四种。

The type of lay and twist direction of steel wire rope

Laying type of steel wire rope means the spiral direction of strands in the steel wire rope or wires in the strand. The steel wire rope has two kinds of laying type: Regular lay and lang lay wire rope. Laying type of steel wire rope is usually divided into four types: right hand regular lay, left hand regular lay, right hand lang lay and left hand lang lay.



右交互捻
绳是右向捻，股是左向捻

Right hand regular lay
Rope is right hand lay, strand is left hand lay.



左交互捻
绳是左向捻，股是右向捻

Left hand regular lay
Rope is left hand lay, strand is right hand lay.



右同向捻
绳和股均为右向捻

Right hand lang lay
Both the rope and strand are right hand lay.



左同向捻
绳和股均为左向捻

Left hand lang lay
Both the rope and strand are left hand lay.

钢丝绳的捻距 钢丝绳的捻距是指钢丝绳绕绳芯旋转一周 (360°) 时所移动的距离。

Length of lay

Length of lay means the distance it moves when the strand revolves round (360°) the rope core.

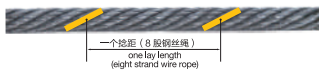

钢丝绳直径的测量方法

正确的钢丝绳测量方法，对于钢丝绳直径的选择以及对于使用过程中钢丝绳直径变化情况资料的积累具有重要的意义。如下图所示，钢丝绳直径的测量方法正确与否，所得到的测量数据将会截然不同。

Steel wire rope diameter measurement method

The correct measurement method of steel wire rope plays an important role in the choice of rope diameter and the information accumulation of the rope diameter change situation during the use process. The measurement data that is obtained will be totally different which depends on whether the measurement method of diameter of steel wire rope is correct or not, shown as the following diagram.

测量工具: 宽钳口游标卡尺

Measuring tool: Wide jaw vernier caliper

测量方法: 钢丝绳的实测直径测量，应用带有宽钳口的游标卡尺来测量，其钳口的宽度最少要以跨越两个相邻的股。测量应在钢丝绳接头 15m 外的平直部位上进行，在相距至少 1m 的两截面上，并在同一截面互相垂直地测取两个数值，四次测量结果的平均值，即为钢丝绳的实测直径。

Measurement method: The measured diameter of the wire rope shall be measured by a vernier caliper with a wide jaw, at least wide enough to span two adjacent strands. The measurement should be carried out on the straight part 15m away from the end of the wire rope, on two sections at least 1m apart, and two values are measured perpendicular to each other in the same section. The average value of the four measurement results is the measured diameter of the wire rope.

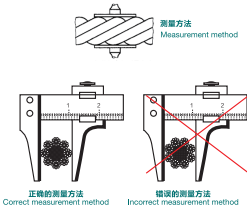

钢丝绳构成分解图 Structure decomposition graph of steel wire rope

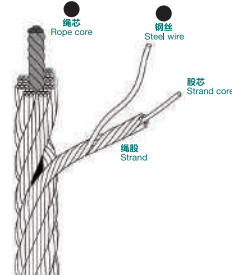

钢丝绳: 由一定数量钢丝一股或多股的股绕成螺旋状而形成的结构
Steel wire rope: the structure which is formed by one layer or various layers of strands winding into helical form by a certain quantity of steel wires

绳芯 (rope core):

- 纤维芯 FC (Fibre Core), 包含:
 - a. 天然纤维芯 NFC (如: 剑麻芯、黄麻芯、棉麻芯);
 - b. 合成纤维芯 SFC (如: 丙纶芯、PP 芯);
 - c. 天然和合成纤维混合芯 CFC
- 钢芯 W.C. 包含:
 - a. 钢丝芯 W.S.C;
 - b. 独立钢丝芯 IWRC;
 - c. 混合钢芯 C.S.C

钢丝绳使用的曳引方式 Hoist way of steel wire rope

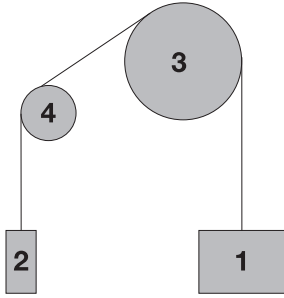

曳引比: 1:1 单绕
Hoist rope ratio: 1:1 single wind

★ 优先推荐使用
Recommended

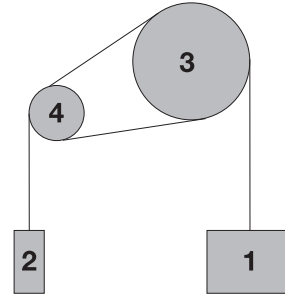

曳引比: 1:1 复绕
Hoist rope ratio: 1:1 rewind

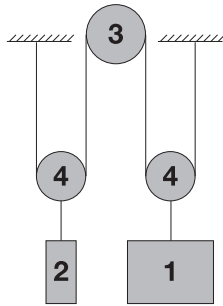

曳引比: 2:1 单绕
Hoist rope ratio: 2:1 single wind

★ 优先推荐使用
Recommended

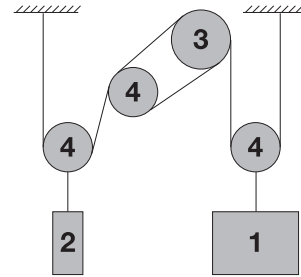

曳引比: 2:1 复绕
Hoist rope ratio: 2:1 rewind

- | | |
|-------------|--------------------------------------|
| 1. 轿厢 | Elevator car |
| 2. 平衡块 | Counterbalance |
| 3. 曳引轮 | Traction wheel |
| 4. 过线滑轮、导向轮 | Over-line pulley and directive wheel |

曳引轮绳槽类型 Types of rope groove of traction wheel

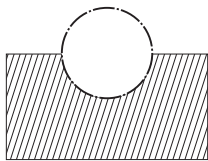

“U” 型槽
“U” type groove

★ 优先推荐使用
Recommended

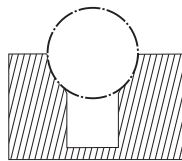

“U” 型开口槽
“U” type open slot

★ 优先推荐使用
Recommended

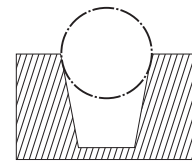

“V” 型槽
“V” type groove

OX-200张紧装置

OX-200 Tension Device

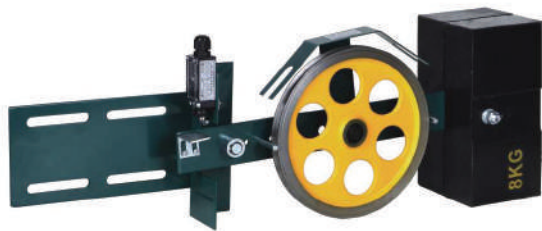

绳轮节圆直径: $\Phi 200\text{mm}$; $\Phi 240\text{mm}$

限速器绳公称直径: $\Phi 6\text{mm}$; $\Phi 8\text{mm}$

配重类型: 重晶石/高密度矿石、铸铁

安装位置: 曳引导轨侧

结构形式: 连杆式

Sheave diameter: $\Phi 200\text{mm}$; $\Phi 240\text{mm}$

Speed limit wire rope nominal diameter: $\Phi 6\text{mm}$; $\Phi 8\text{mm}$

Weight type: Barite/High density of ores, cast iron

Installation position: elevator pit/guide rail side

Structure form: link rod

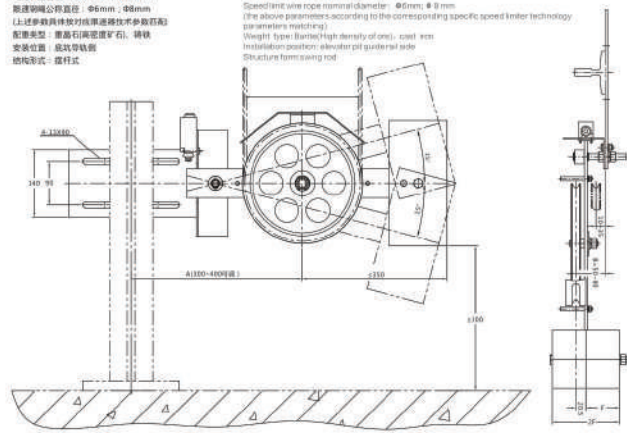

| 绳轮节圆直径 Sheave diameter | 限速器绳公称直径 Speed limit wire rope nominal diameter | A | B | 配重重量 Weight | 绳轮形式 Sheave type |
|---------------------------|--|-----|-----|----------------|---------------------|
| $\Phi 200$ | $\Phi 6$ | 210 | 80 | 200 | 铸钢 |
| $\Phi 200$ | $\Phi 8$ | 210 | 80 | 210 | 铸钢 |
| $\Phi 240$ | $\Phi 6$ | 250 | 100 | 200 | 铸钢 |
| $\Phi 240$ | $\Phi 8$ | 250 | 100 | 210 | 铸钢 |

| 配重重量 Weight | 配重材料 Weight material | E | F | G |
|----------------|-------------------------|-----|----|-----|
| 200g | 铸钢 | 210 | 40 | 85 |
| 210g | 铸钢 | 210 | 50 | 100 |
| 120g | 铸钢 | 200 | 30 | 100 |
| 100g | 铸钢 | 200 | 20 | 100 |
| 100g | 重晶石 | 200 | 30 | 100 |
| 100g | 重晶石 | 200 | 40 | 100 |

1. 上表中带*的绳轮形式为选配参数，具体参数和绳轮形式按实际计算确定；
2. 表中为配重重量参数列表，具体重量按实际配重确定。

OX-300张紧装置

OX-300 Tension Device

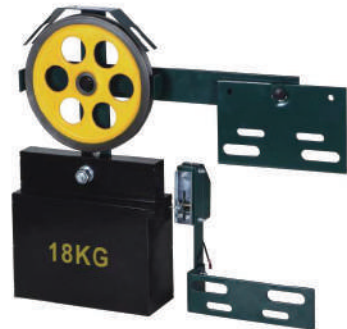

| 绳轮节圆直径 Sheave diameter | 限速器绳公称直径 Speed limit wire rope nominal diameter | A | B | 配重重量 Weight | 绳轮形式 Sheave type |
|---------------------------|--|-----|-----|----------------|---------------------|
| $\Phi 200$ | $\Phi 6$ | 210 | 80 | 200 | 铸钢 |
| $\Phi 200$ | $\Phi 8$ | 210 | 80 | 210 | 铸钢 |
| $\Phi 240$ | $\Phi 6$ | 250 | 100 | 200 | 铸钢 |
| $\Phi 240$ | $\Phi 8$ | 250 | 100 | 210 | 铸钢 |

| 配重重量 Weight | 配重材料 Weight material | D | E | F | G |
|----------------|-------------------------|-----|----|-----|-----|
| 200g | 铸钢 | 210 | 40 | 85 | 85 |
| 210g | 铸钢 | 210 | 50 | 100 | 100 |
| 120g | 铸钢 | 200 | 30 | 100 | 100 |
| 100g | 铸钢 | 200 | 20 | 100 | 100 |
| 100g | 重晶石 | 200 | 30 | 100 | 100 |
| 100g | 重晶石 | 200 | 40 | 100 | 100 |

绳轮节圆直径: $\Phi 200\text{mm}$; $\Phi 240\text{mm}$

限速器绳公称直径: $\Phi 6\text{mm}$; $\Phi 8\text{mm}$

配重类型: 重晶石/高密度矿石、铸铁

安装位置: 曳引导轨侧

Sheave diameter: $\Phi 200\text{mm}$; $\Phi 240\text{mm}$

Speed limit wire rope nominal diameter: $\Phi 6\text{mm}$; $\Phi 8\text{mm}$

Weight type: Barite/High density of ores, cast iron

Installation position: elevator pit/guide rail side

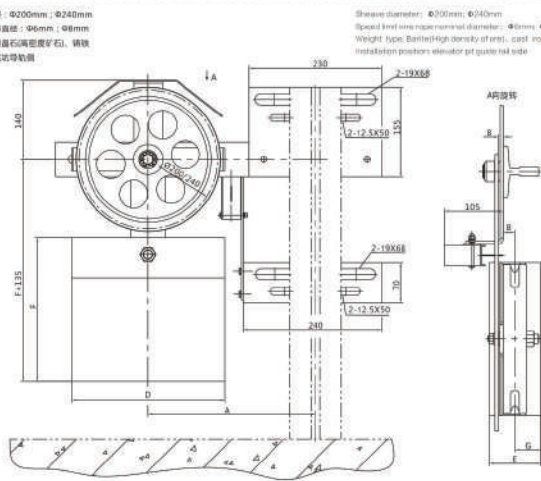

OX-300A张紧装置

OX-300A Tension Device



| 绳轮节圆直径 Sheave diameter | 限速器绳公称直径 Speed limit wire rope nominal diameter | A | B | 配重重量 Weight | 绳轮形式 Sheave type |
|---------------------------|--|-----|-----|----------------|---------------------|
| $\Phi 200$ | $\Phi 6$ | 210 | 80 | 200 | 铸钢 |
| $\Phi 200$ | $\Phi 8$ | 210 | 80 | 210 | 铸钢 |
| $\Phi 240$ | $\Phi 6$ | 250 | 100 | 200 | 铸钢 |
| $\Phi 240$ | $\Phi 8$ | 250 | 100 | 210 | 铸钢 |

| 配重重量 Weight | 配重材料 Weight material | D | E | F | G |
|----------------|-------------------------|-----|----|-----|-----|
| 200g | 铸钢 | 210 | 40 | 85 | 85 |
| 210g | 铸钢 | 210 | 50 | 100 | 100 |
| 120g | 铸钢 | 200 | 30 | 100 | 100 |
| 100g | 铸钢 | 200 | 20 | 100 | 100 |
| 100g | 重晶石 | 200 | 30 | 100 | 100 |
| 100g | 重晶石 | 200 | 40 | 100 | 100 |

绳轮节圆直径: $\Phi 200\text{mm}$; $\Phi 240\text{mm}$

限速器绳公称直径: $\Phi 6\text{mm}$; $\Phi 8\text{mm}$

配重类型: 重晶石/高密度矿石、铸铁

安装位置: 曳引导轨侧

Sheave diameter: $\Phi 200\text{mm}$; $\Phi 240\text{mm}$

Speed limit wire rope nominal diameter: $\Phi 6\text{mm}$; $\Phi 8\text{mm}$

Weight type: Barite/High density of ores, cast iron

Installation position: elevator pit/guide rail side

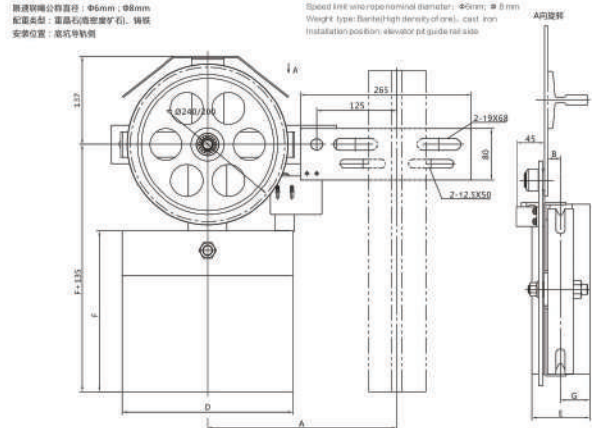

OX-100A张紧装置

OX-100A Tension Device



绳轮节圆直径: $\Phi 150\text{mm}$

限速器绳公称直径: $\Phi 6\text{mm}$

配重类型: 无(采用弹簧装置, 安装时调整绳位)

安装位置: 曳引导轨(注意防碰)

Sheave diameter: $\Phi 150\text{mm}$

Speed limit wire rope nominal diameter: $\Phi 6\text{mm}$

Weight type: none (use spring tension device, adjust setting after installed)

Installation position: elevator ground pit (keep away from obstacle)

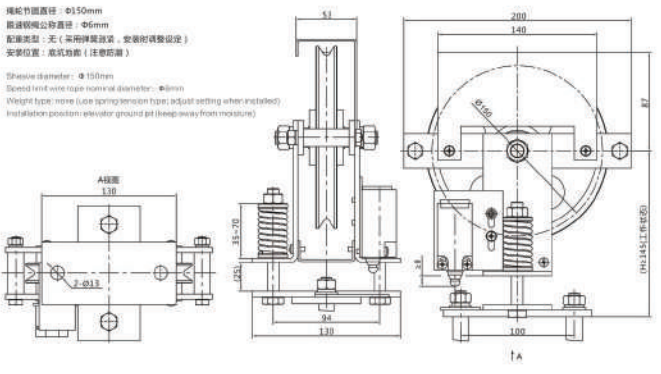

油压缓冲器
Oil Buffer

系统质量：具体参数见汇总表
执行标准：GB7588-2003, EN81-1:1998
结构规格：HL46液压油
产品类型：耗能型

System quality: specific parameter summary table
Execution standard: GB7588-2003, EN81-1:1998
The oil specification: HL46 hydraulic oil
Product type: energy-consuming type

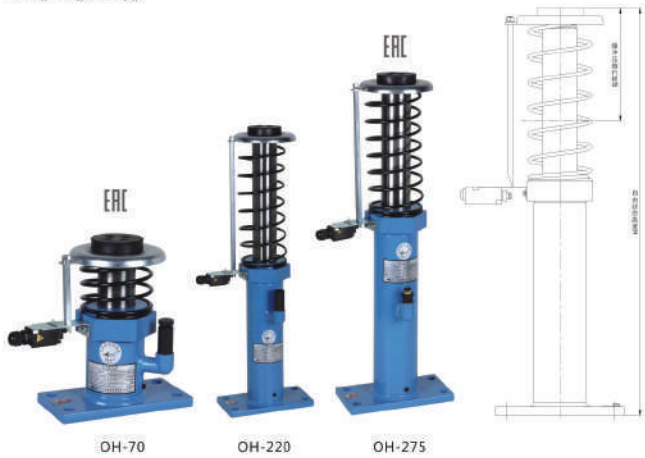

| 型号 | 压缩行程 (mm) | 自由状态高度 (mm) | 缓冲尺寸 (mm) | 安装尺寸 (mm) |
|--------|--------------|----------------|--------------|--------------|
| OH-70 | 70 | 305 | 125x250 | 80x110 |
| OH-220 | 220 | 780 | 125x250 | 80x110 |
| OH-275 | 275 | 798 | 125x250 | 80x110 |

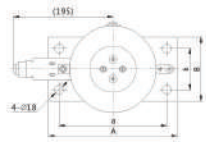

油压缓冲器
Oil Buffer

系统质量：具体参数见汇总表
执行标准：GB7588-2003, EN81-1:1998
结构规格：HL46液压油
产品类型：耗能型

System quality: specific parameter summary table
Execution standard: GB7588-2003, EN81-1:1998
The oil specification: HL46 hydraulic oil
Product type: energy-consuming type



| 型号 | 压缩行程 (mm) | 自由状态高度 (mm) | 缓冲尺寸 (mm) | 安装尺寸 (mm) |
|--------|--------------|----------------|--------------|--------------|
| OH-65 | 65 | 300 | 180x100 | 100x150 |
| OH-80A | 80 | 405 | 180x100 | 100x150 |
| OH-425 | 425 | 1130 | 180x100 | 100x150 |

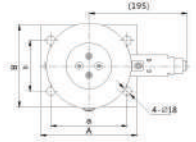

油压缓冲器
Oil Buffer

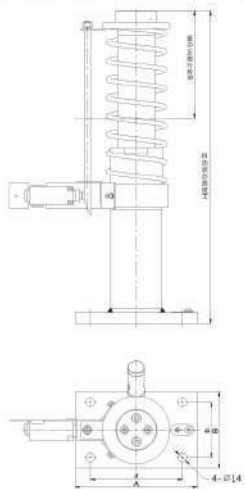

系统质量：具体参数见汇总表
执行标准：GB7588-2003, EN81-1:1998
结构规格：HL46液压油
产品类型：耗能型

System quality: for detailed parameters, see summary table
Performance standard: GB7588-2003, EN81-1:1998
Oil specification: HL46 hydraulic oil
Product type: energy-consuming

| 型号 | 压缩行程 (mm) | 自由状态高度 (mm) | 缓冲尺寸 (mm) | 安装尺寸 (mm) |
|--------|--------------|----------------|--------------|--------------|
| OH-80 | 80 | 111 | 125 x 200 | 80 x 130 |
| OH-175 | 175 | 189 | 125 x 200 | 80 x 130 |
| OH-210 | 210 | 200 | 125 x 200 | 80 x 130 |

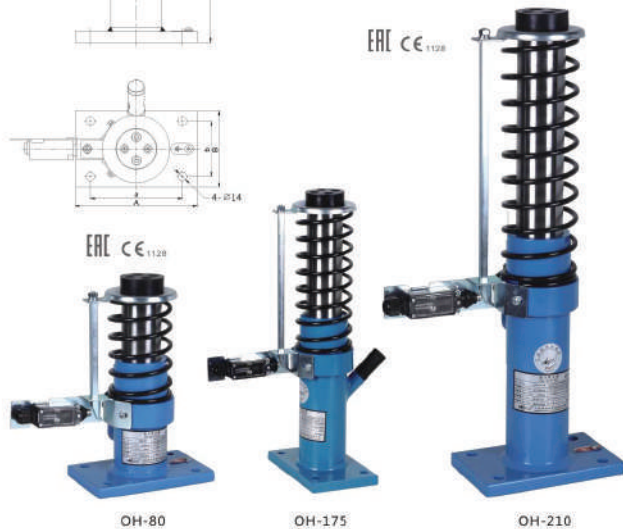

油压缓冲器
Oil Buffer

系统质量：具体参数见汇总表
执行标准：GB7588-2003, EN81-1:1998
结构规格：HL46液压油
产品类型：有源弹簧

System quality: for detailed parameters, see summary table
Performance standard: GB7588-2003, EN81-1:1998
Oil specification: HL46 hydraulic oil
Product type: energy-consuming (buft-in-spring)

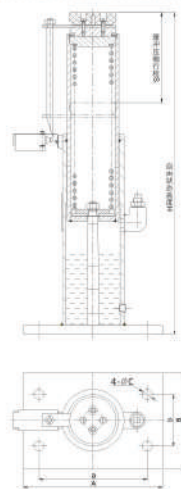

| 型号 | 压缩行程 (mm) | 自由状态高度 (mm) | 缓冲尺寸 (mm) | 安装尺寸 (mm) | 安装间距孔距 |
|-------|--------------|----------------|--------------|--------------|--------|
| OH-10 | 100 | 380 | 125x180 | 80x100 | 18 |
| OH-16 | 170 | 525 | 150x270 | 100x210 | 18 |
| OH-20 | 250 | 610 | 150x270 | 100x210 | 18 |

聚氨酯缓冲器
Polyurethane Buffer

系统质量：具体参数见汇总表
执行标准：GB7588-2003, EN81-1:1998
产品类型：蓄能型

System quality: for detailed parameters, see summary table
Execution standard: GB7588-2003, EN81-1:1998
Product type: Energy storing type



| 型号 | 自由状态高度 (mm) | 缓冲尺寸 (mm) | 安装尺寸 (mm) |
|--------|----------------|--------------|--------------|
| OH-J11 | 80 | 130x130 | 25x60 |
| OH-J21 | 150 | 190x160 | 25x110 |

OX-029 导轨
OX - 029 Guide Shoe



适用速度: $\leq 1.75\text{m/s}$
额定载荷: $\leq 1350\text{kg}$
正向压力: $\leq 1050\text{N}$
侧向压力: $\leq 750\text{N}$
匹配导轨: 实心轨 9, 10, 16
匹配鞋衬: OX-450T

speed of application: $\leq 1.75\text{m/s}$
rated load: $\leq 1350\text{kg}$
Front pressure: $\leq 1050\text{N}$
Side pressure: $\leq 750\text{N}$
Matching guide rail: solid rail 9, 10, 16
Matching shoe lining: OX-450T

| 规格型号 | A | B | C | 备注 |
|------|-----|----|----|----|
| AX1 | 120 | 20 | 20 | |
| AX2 | 170 | 20 | 20 | |
| AX3 | 120 | 10 | 20 | |

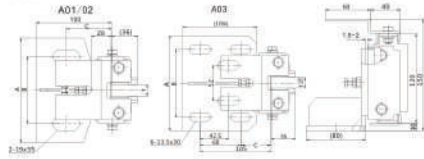

OX-310F 导轨
OX - 310F Guide Shoe



适用速度: $\leq 2.5\text{m/s}$
额定载荷: $\leq 1350\text{kg}$
正向压力: $\leq 1250\text{N}$
侧向压力: $\leq 850\text{N}$
匹配导轨: 实心轨 9, 10, 16
匹配鞋衬: OX-450Z

speed of application: $\leq 2.5\text{m/s}$
rated load: $\leq 1350\text{kg}$
Front pressure: $\leq 1250\text{N}$
Side pressure: $\leq 850\text{N}$
Matching guide rail: solid rail 9, 10, 16
Matching shoe lining: OX-450Z

| 规格型号 | A | B | C | 备注 |
|------|-----|----|----|----|
| AX1 | 120 | 20 | 20 | |
| AX2 | 170 | 20 | 20 | |
| AX3 | 120 | 10 | 20 | |

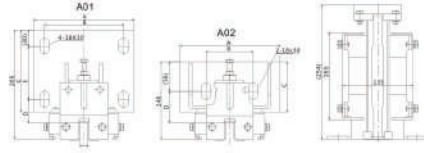

OX-310M 导轨
OX - 310M Guide Shoe



适用速度: $\leq 2.5\text{m/s}$
额定载荷: $\leq 1350\text{kg}$
正向压力: $\leq 1250\text{N}$
侧向压力: $\leq 850\text{N}$
匹配导轨: 实心轨 9, 16
匹配鞋衬: OX-450Y

speed of application: $\leq 2.5\text{m/s}$
rated load: $\leq 1350\text{kg}$
Front pressure: $\leq 1250\text{N}$
Side pressure: $\leq 850\text{N}$
Matching guide rail: solid rail 9, 16
Matching shoe lining: OX-450Y

| 规格型号 | A | B | C | 备注 |
|------|-----|----|----|----|
| AX1 | 120 | 20 | 20 | |
| AX2 | 170 | 20 | 20 | |
| AX3 | 120 | 10 | 20 | |

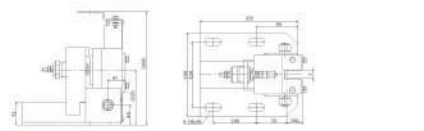

OX-B22 导轨
OX - B22 Guide Shoe



适用速度: $\leq 2.0\text{m/s}$
额定载荷: $\leq 1250\text{kg}$
正向压力: $\leq 1000\text{N}$
侧向压力: $\leq 700\text{N}$
匹配导轨: 实心轨 10, 14
匹配鞋衬: OX-450A/B

speed of application: $\leq 2.0\text{m/s}$
rated load: $\leq 1250\text{kg}$
Front pressure: $\leq 1000\text{N}$
Side pressure: $\leq 700\text{N}$
Matching guide rail: solid rail 10, 14
Matching shoe lining: OX-450A/B

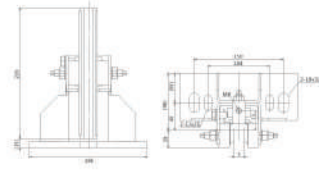

OX-B22-1 导轨
OX - B22-1 Guide Shoe



适用速度: $\leq 2.0\text{m/s}$
额定载荷: $\leq 1250\text{kg}$
正向压力: $\leq 1000\text{N}$
侧向压力: $\leq 700\text{N}$
匹配导轨: 实心轨 10, 14
匹配鞋衬: OX-450A/B

speed of application: $\leq 2.0\text{m/s}$
rated load: $\leq 1250\text{kg}$
Front pressure: $\leq 1000\text{N}$
Side pressure: $\leq 700\text{N}$
Matching guide rail: solid rail 10, 14
Matching shoe lining: OX-450A/B

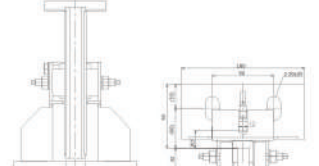

OX-129 导轨
OX - 129 Guide Shoe

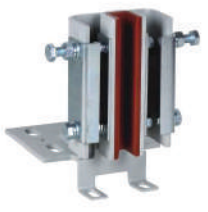

适用速度: $\leq 2.0\text{m/s}$
额定载荷: $\leq 1600\text{kg}$
正向压力: $\leq 1000\text{N}$
侧向压力: $\leq 1350\text{N}$
匹配导轨: 实心轨 16
匹配鞋衬: OX-450Y

speed of application: $\leq 2.0\text{m/s}$
rated load: $\leq 1600\text{kg}$
Front pressure: $\leq 1000\text{N}$
Side pressure: $\leq 1350\text{N}$
Matching guide rail: solid rail 16
Matching shoe lining: OX-450Y

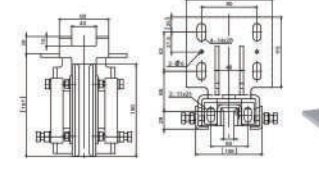

OX-02 导轨
OX - 02 Guide Shoe



适用速度: $\leq 1.0\text{m/s}$
额定载荷: $\leq 3500\text{kg}$
正向压力: $\leq 1450\text{N}$
侧向压力: $\leq 1450\text{N}$
匹配导轨: 实心轨 10, 16
匹配鞋衬: OX-450P/Q

speed of application: $\leq 1.0\text{m/s}$
rated load: $\leq 3500\text{kg}$
Front pressure: $\leq 1450\text{N}$
Side pressure: $\leq 1450\text{N}$
Matching guide rail: solid rail 10, 16
Matching shoe lining: OX-450P/Q

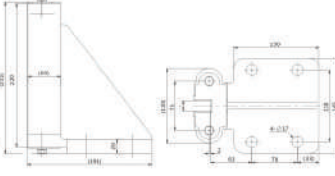

OX-07 导轨
OX - 07 Guide Shoe

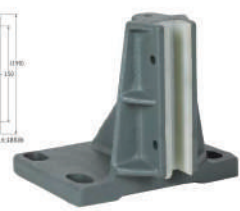

适用速度: $\leq 0.63\text{m/s}$
额定载荷: $\leq 2000\text{kg}$
正向压力: $\leq 1150\text{N}$
侧向压力: $\leq 1450\text{N}$
匹配导轨: 实心轨 10, 16
匹配鞋衬: OX-450C/D(150)

speed of application: $\leq 0.63\text{m/s}$
rated load: $\leq 2000\text{kg}$
Front pressure: $\leq 1150\text{N}$
Side pressure: $\leq 1450\text{N}$
Matching guide rail: solid rail 10, 16
Matching shoe lining: OX-450C/D(150)

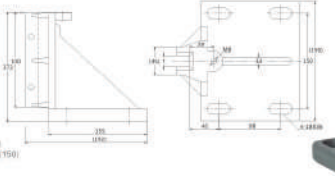

OX-03 导轨
OX - 03 Guide Shoe



适用速度: $\leq 1.75\text{m/s}$
额定载荷: $\leq 2000\text{kg}$
正向压力: $\leq 1450\text{N}$
侧向压力: $\leq 1450\text{N}$
匹配导轨: 实心轨 10, 16
匹配鞋衬: OX-450C/D

speed of application: $\leq 1.75\text{m/s}$
rated load: $\leq 2000\text{kg}$
Front pressure: $\leq 1450\text{N}$
Side pressure: $\leq 1450\text{N}$
Matching guide rail: solid rail 10, 16
Matching shoe lining: OX-450C/D

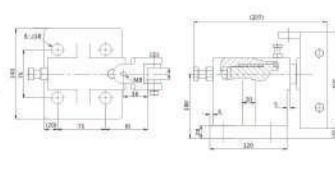

OX-T15 导轨
OX - T15 Guide Shoe



适用速度: $\leq 2.5\text{m/s}$
额定载荷: $\leq 1400\text{kg}$
正向压力: $\leq 1450\text{N}$
侧向压力: $\leq 1450\text{N}$
匹配导轨: 实心轨 10, 16
匹配鞋衬: OX-450C/D(150)

speed of application: $\leq 2.5\text{m/s}$
rated load: $\leq 1400\text{kg}$
Front pressure: $\leq 1450\text{N}$
Side pressure: $\leq 1450\text{N}$
Matching guide rail: solid rail 10, 16
Matching shoe lining: OX-450C/D(150)

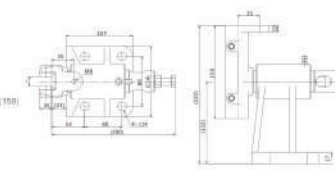

OX-05 导轨
OX - 05 Guide Shoe



适用速度: $\leq 0.63\text{m/s}$
额定载荷: $\leq 3800\text{kg}$
正向压力: $\leq 1800\text{N}$
侧向压力: $\leq 1450\text{N}$
匹配导轨: 实心轨 10, 16
匹配鞋衬: OX-450P/Q

speed of application: $\leq 0.63\text{m/s}$
rated load: $\leq 3800\text{kg}$
Front pressure: $\leq 1800\text{N}$
Side pressure: $\leq 1450\text{N}$
Matching guide rail: solid rail 10, 16
Matching shoe lining: OX-450P/Q

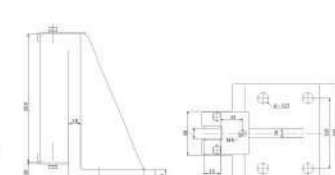

OX-T22 导轨
OX - T22 Guide Shoe



适用速度: $\leq 2.5\text{m/s}$
额定载荷: $\leq 3000\text{kg}$
正向压力: $\leq 1780\text{N}$
侧向压力: $\leq 1450\text{N}$
匹配导轨: 实心轨 10, 16
匹配鞋衬: OX-450C/D(220)

speed of application: $\leq 2.5\text{m/s}$
rated load: $\leq 3000\text{kg}$
Front pressure: $\leq 1780\text{N}$
Side pressure: $\leq 1450\text{N}$
Matching guide rail: solid rail 10, 16
Matching shoe lining: OX-450C/D(220)

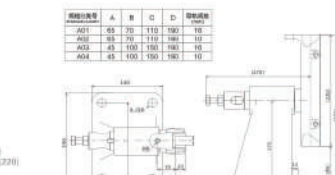

OX-T26 导靴
OX - T26 Guide Shoe



适用速度: $\leq 1.75\text{m/s}$
额定载荷: $\leq 2500\text{kg}$
正向压力: $\leq 1600\text{N}$
侧向压力: $\leq 1400\text{N}$
匹配身轨: 实心轨10, 16
匹配靴材: OX-450P/Q(220)

speed of application: $\leq 1.75\text{m/s}$
rated load: $\leq 2500\text{kg}$
front pressure: $\leq 1600\text{N}$
side pressure: $\leq 1400\text{N}$
Matching guide rail: solid rail 10, 16
Matching shoe lining: OX - 450P/Q(220)

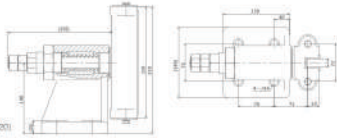

OX-T28 导靴
OX - T28 Guide Shoe



适用速度: $\leq 1.75\text{m/s}$
额定载荷: $\leq 2500\text{kg}$
正向压力: $\leq 1600\text{N}$
侧向压力: $\leq 1600\text{N}$
匹配身轨: 实心轨10, 16
匹配靴材: OX-450P/Q(220)

speed of application: $\leq 1.75\text{m/s}$
rated load: $\leq 2500\text{kg}$
front pressure: $\leq 1600\text{N}$
side pressure: $\leq 1600\text{N}$
Matching guide rail: solid rail 10, 16
Matching shoe lining: OX - 450P/Q(220)

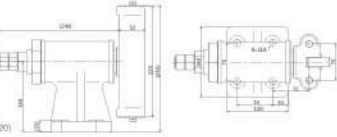

OX-028 导靴
OX - 028 Guide Shoe



适用速度: $\leq 1.75\text{m/s}$
额定载荷: $\leq 1600\text{kg}$
匹配身轨: 实心轨16
匹配靴材: OX-450C/D(150)

speed of application: $\leq 1.75\text{m/s}$
rated load: $\leq 1600\text{kg}$
Matching guide rail: solid rail 16
Matching shoe lining: OX-450C/D(150)

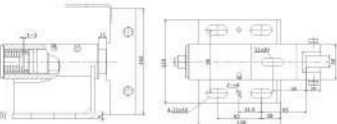

OX-310H 导靴
OX - 310H Guide Shoe

适用速度: $\leq 1.75\text{m/s}$
额定载荷: $\leq 120\text{kg}$
匹配身轨: 实心轨10
匹配靴材: OX-450H

speed of application: $\leq 1.75\text{m/s}$
rated load: $\leq 120\text{kg}$
Matching guide rail: solid rail 10
Matching shoe lining: OX - 450H

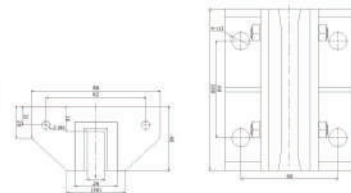

OX-310G 导靴
OX - 310G Guide Shoe

适用速度: $\leq 1.75\text{m/s}$
适用位置: 对重空心轨10, 16.4
匹配靴材: OX-450G/J

speed of application: $\leq 1.75\text{m/s}$
Matching guide rail: hollow rail 10, 16.4
Matching shoe lining: OX - 450G/J

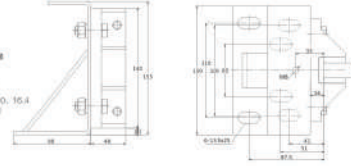

OX-310GW 导靴
OX - 310GW Guide Shoe

适用速度: $\leq 1.75\text{m/s}$
适用位置: 对重空心轨10, 16.4
匹配靴材: OX-450G/J

speed of application: $\leq 1.75\text{m/s}$
Matching guide rail: hollow rail 10, 16.4
Matching shoe lining: OX - 450G/J

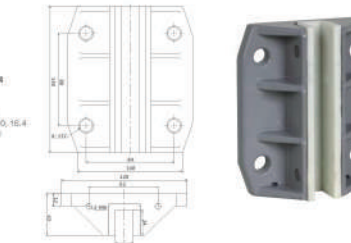

OX-847 导靴
OX - 847 Guide Shoe



适用速度: $\leq 1.75\text{m/s}$
匹配身轨: 对重轨10, 16.4
匹配靴材: OX-847W

speed of application: $\leq 1.75\text{m/s}$
Matching guide rail: hollow rail 10, 16.4
Matching shoe lining: OX - 847W

| 靴靴分类型 | A | B | C |
|-------|----|----|-------|
| A01 | 70 | 75 | 16x35 |
| A02 | 60 | 75 | 16x35 |
| A03 | 70 | 75 | 16x35 |

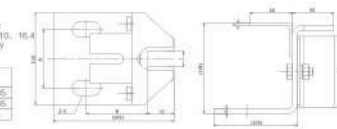

OX-L10 导靴
OX - L10 Guide Shoe

适用速度: $\leq 1.75\text{m/s}$
匹配身轨: 对重轨5, 10, 16.4
匹配靴材: OX-450G

speed of application: $\leq 1.75\text{m/s}$
Matching guide rail: hollow rail 5, 10, 16.4
Matching shoe lining: OX - 450G

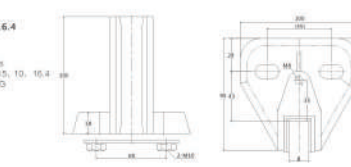

OX-847W 导靴
OX - 847W Guide Shoe



适用速度: $\leq 1.75\text{m/s}$
匹配身轨: 对重轨10, 16.4

speed of application: $\leq 1.75\text{m/s}$
Matching guide rail: hollow rail 10, 16.4

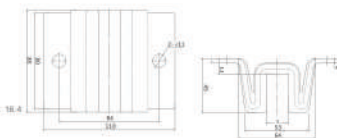

OX-GL76 导靴
OX - GL76 Guide Shoe

适用速度: $\leq 1.75\text{m/s}$
额定载荷: $\leq 1250\text{kg}$
匹配身轨: 实心轨10, 16

speed of application: $\leq 1.75\text{m/s}$
rated load: $\leq 1250\text{kg}$
Matching guide rail: solid rail 10, 16

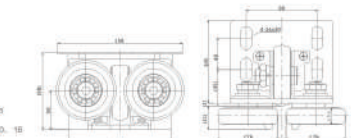

OX-019 导靴
OX - 019 Guide Shoe

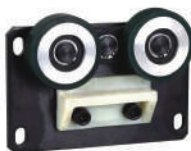

适用速度: $\leq 0.63\text{m/s}$
额定载荷: $\leq 630\text{kg}$
匹配身轨: 实心轨10

speed of application: $\leq 0.63\text{m/s}$
rated load: $\leq 630\text{kg}$
Matching guide rail: solid rail 10

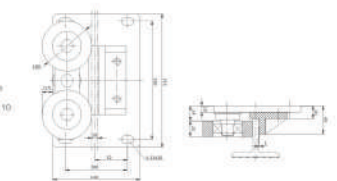

OX-GL100 导靴
OX - GL100 Guide Shoe

适用速度: $\leq 2.5\text{m/s}$
额定载荷: $\leq 1250\text{kg}$
匹配身轨: 实心轨10, 16

speed of application: $\leq 2.5\text{m/s}$
rated load: $\leq 1250\text{kg}$
Matching guide rail: solid rail 10, 16

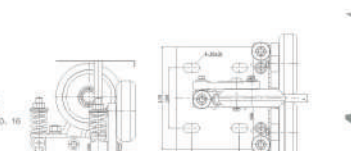

OX-450 A/B靴衬
OX - 450A/B Shoe Lining



匹配导轨: 10, 16
Matching lead rail: 10, 16

OX-450 C/D靴衬
OX - 450C/D Shoe Lining

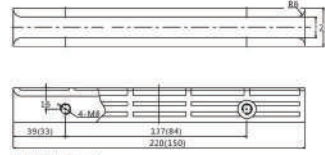
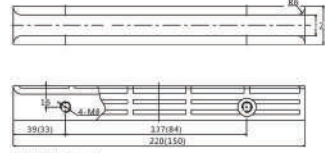

匹配导轨: 10, 16
Matching lead rail: 10, 16

OX-450 E/F靴衬
OX - 450E/F Shoe Lining

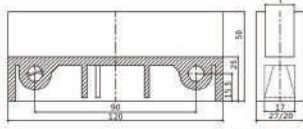

匹配导轨: 10, 16
Matching lead rail: 10, 16

OX-450 G靴衬
OX - 450G Shoe Lining

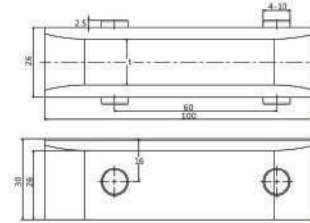
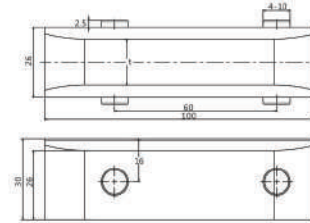

匹配导轨: 5, 10, 16, 4
Matching lead rail: 5, 10, 16, 4

OX-450 I/J靴衬
OX - 450I/J Shoe Lining

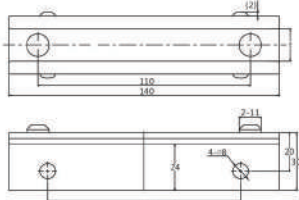

匹配导轨: 10, 16
Matching lead rail: 10, 16

OX-450 P/Q靴衬
OX - 450P/Q Shoe Lining

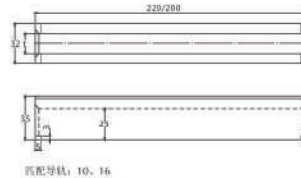
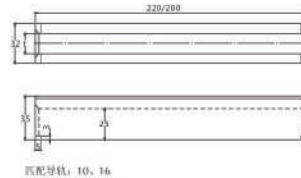

匹配导轨: 10, 16
Matching lead rail: 10, 16

OX-450T靴衬
OX - 450T Shoe Lining

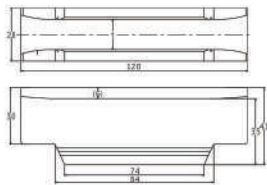

匹配导轨: 9, 10, 16
Matching lead rail: 9, 10, 16

OX-450Z靴衬
OX - 450Z Shoe Lining

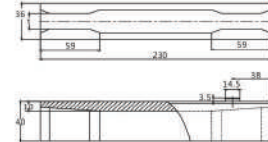
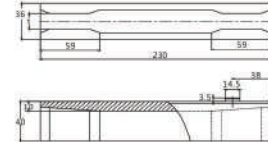

匹配导轨: 10, 16
Matching lead rail: 10, 16

OX-450N靴衬
OX - 450N Shoe Lining

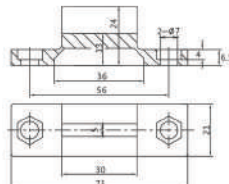

匹配导轨: 5
Matching lead rail: 5

OX-450I靴衬
OX - 450I Shoe Lining

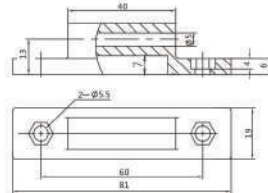
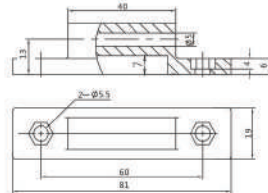

OX-450H靴衬
OX - 450H Shoe Lining

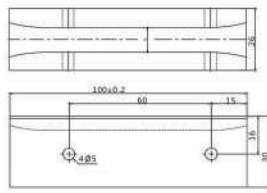

匹配导轨: 10
Matching lead rail: 10

OX-450Y靴衬
OX - 450Y Shoe Lining

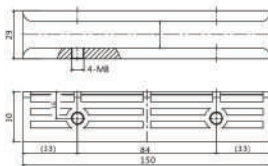
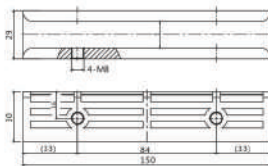

匹配导轨: 10, 16
Matching lead rail: 10, 16

OX-510A检修箱

OX - 510A Maintenance Box

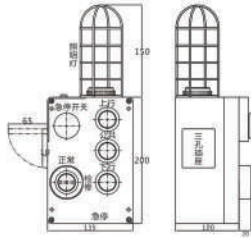

OX-510B检修箱

OX - 510B Maintenance Box

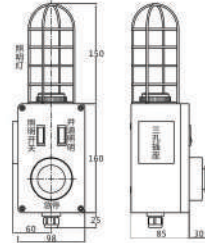

OX-510C检修箱

OX - 510C Maintenance Box

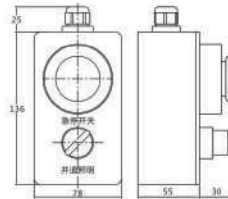

OX-320D超载装置

OX - 320D Overload Device

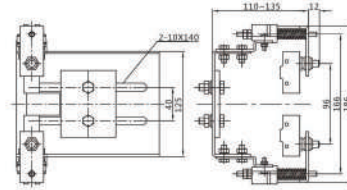

OX-FB9B风机

OX - FB9B Fan

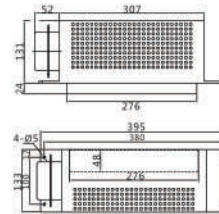

OX-RAR圆风扇

OX - RAR Round Fan

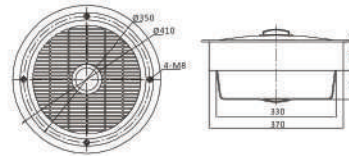

OX-320A减震垫

OX - 320A Shock Pad

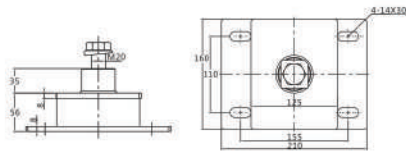

OX-320E轿顶卡板

OX - 320E Chuck Of Car top

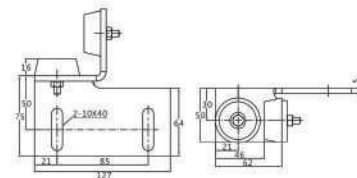

OX-320B减震垫

OX - 320B Shock Pad

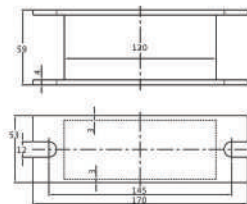

OX-320F防偏装置

OX - 320F Partial Prevention Device

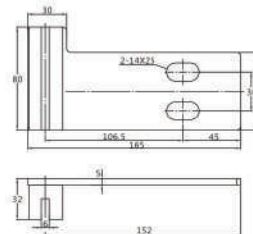

OX-320C防偏装置

OX - 320C Partial Prevention Device

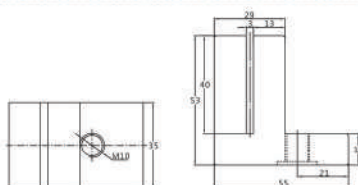

OX-310C导靴

OX - 310C Guide Shoe

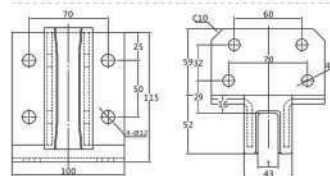

适用速度: $\leq 1.75\text{m/s}$
 额定载重: $\leq 320\text{kg}$
 适配导轨: 对槽型10, 16.4
 Fan speed: $\leq 1.75\text{ m/s}$
 Load rating: $\leq 320\text{kg}$
 Matching guide: solid track 10, 16.4





DUBAI



ABU DHABI



AL AIN



SHARJAH

+ 971 50 103 5499

+ 971 60058333

+ 971 55 515 0030

Info@smou.ae - info@smoulift.com

www.smoulift.com

KUWAIT - HAWALLI

Block 7 Building No.12A

Mob : + 965 6083 8834

Tel : + 965 549 3866

KUWAIT

HEAD OFFICE

Kingdom of Saudi Arabia

Riyadh , Al Sahafa Destrict

Mob : + 966 56 440 0098

Tel : + 966 11 222 9151

AL HASA BRANCH

Kingdom of Saudi Arabia

Al-Qetar Street Intersection

Mob : + 966 54 097 7973

Tel : + 966 13 573 2730

DAMMAM BRANCH

Kingdom of Saudi Arabia

Zahran St. King Fahd front of

Dammam pals

Mob : + 966 54 037 7078

KSA

DUBAI

Alnahda 1 - Saheel Tower 1

Office : 1405

Mob : + 971 50 103 5499

Tel : + 971 4 220 8861

ABU DHABI

UAE - Captial mall

China Centre

Mob : + 971 55 515 0030

Tel : + 971 4 880 7113

AL AIN

UAE - Sultan bin zaid street

Skeikha Salamh Building

Mob : + 971 50 103 5499

Tel : + 971 3 761 3136

SHARJAH

UAE - Sharjah- Al Majaz1

BelRasheed tower 502

Mob : + 971 50 103 5499

Tel : + 971 3 761 3136

